

Sets are bulk shipped

**Order SHIMS by individual piece or set**

Drawings are not to scale

*Metric shims over 0.25mm thick are black oxidized*

*Slots and holes are centered unless otherwise noted*

**DSCH107 Series - Individual Shims**

DSC Part No.	Description	Thickness
DSCH107-E059	1/4 inch thickness shim	.059 inch

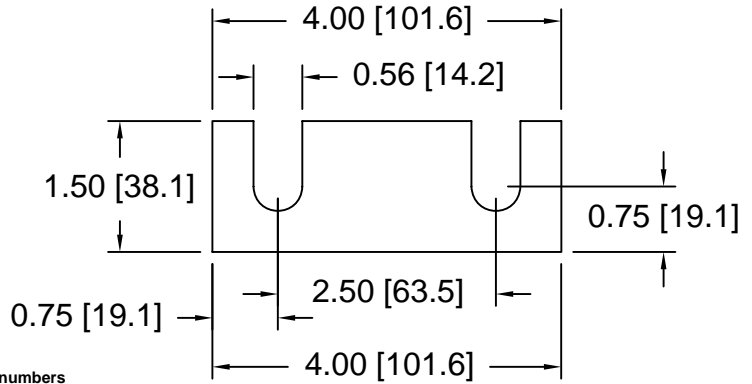

**DSCH107 Series - Shim Sets**

DSC Part No.	Description	Thickness	Set includes	Other part numbers
DSCH107-E244	Four piece inch shim set	.236 inch	(4) .059 inch	D113063

**DSCH108 Series - Individual Shims**

DSC Part No.	Description	Thickness
DSCH108-E059	1/4 inch thickness shim	.059 inch

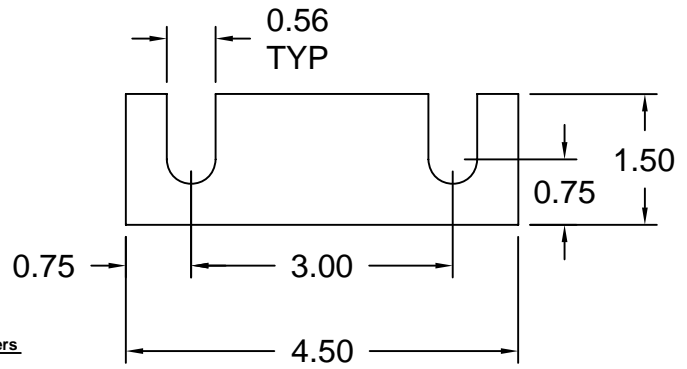

**DSCH108 Series - Shim Sets**

DSC Part No.	Description	Thickness	Set includes	Other part numbers
DSCH108-E244	Four piece inch shim set	.236 inch	(4) .059 inch	D113064

**DSCH109 Series - Individual Shims**

DSC Part No.	Description	Thickness
DSCH109-E059	1/4 inch thickness shim	.059 inch

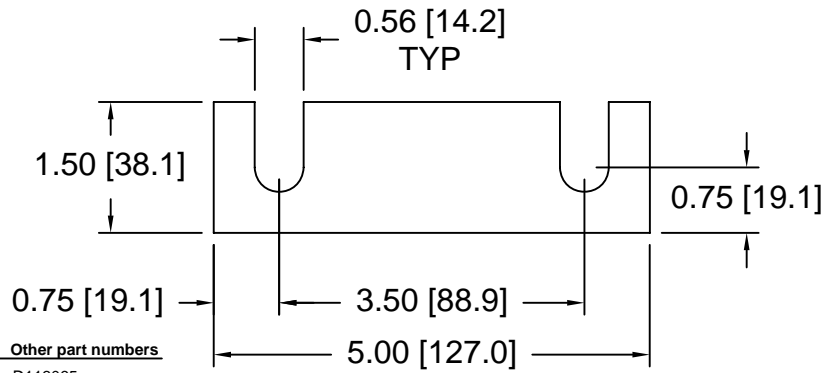

**DSCH109 Series - Shim Sets**

DSC Part No.	Description	Thickness	Set includes	Other part numbers
DSCH109-E244	Four piece inch shim set	.236 inch	(4) .059 inch	D113065

**DSCH110 Series - Individual Shims**

DSC Part No.	Description	Thickness
DSCH110-E059	1/4 inch thickness shim	.059 inch

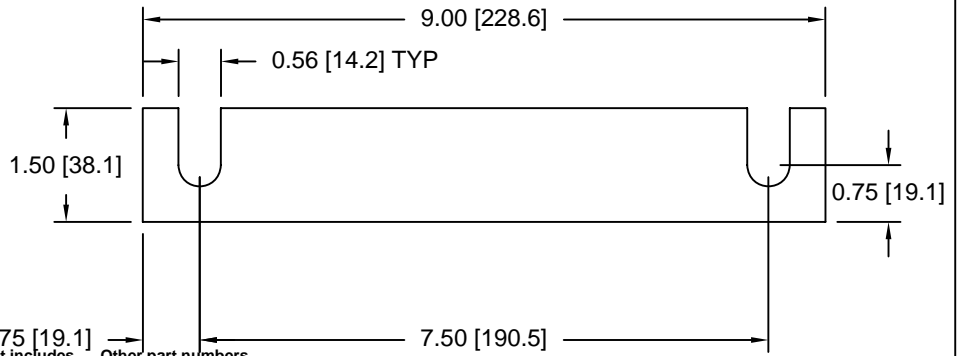

**DSCH110 Series - Shim Sets**

DSC Part No.	Description	Thickness	Set includes	Other part numbers
DSCH110-E244	Four piece inch shim set	.236 inch	(4) .059 inch	D113066

Douglas Stamping Company (248) 542-3940 FAX (248) 542-6342

<http://dougstampco.com> [sales@dougstampco.com](mailto:sales@dougstampco.com)