

Sets are bulk shipped

Order SHIMS by individual piece or set

Drawings are not to scale

Metric shims over 0.25mm thick are black oxidized

Slots and holes are centered unless otherwise noted

DSCH103 Series - Individual Shims

| DSC Part No. | Description | Thickness | Other part numbers |
|--------------|--------------------------|----------------|--------------------|
| DSCH103-E015 | Inch thickness shim..... | .015 inch..... | CSS 1417-3 |
| DSCH103-E032 | Inch thickness shim..... | .031 inch..... | CSS 1417-1 |
| DSCH103-E062 | Inch thickness shim..... | .062 inch..... | CSS 1417-2 |

DSCH103 Series - Shim Sets

| DSC Part No. | Description | Thickness | Set includes |
|--------------|--|----------------|---|
| DSCH103-E155 | Five piece inch shim set..... (This set also known as 42-530-3050) | .150 inch..... | (1) .062 inch, (2) .031 inch, (2) .015 inch |

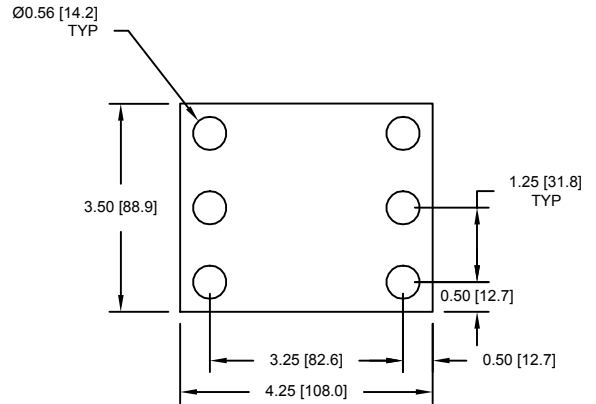

DSCH104 Series - Individual Shims

| DSC Part No. | Description | Thickness | Other part numbers |
|--------------|--------------------------|----------------|--------------------|
| DSCH104-E015 | Inch thickness shim..... | .015 inch..... | CSS 1616-3 |
| DSCH104-E032 | Inch thickness shim..... | .031 inch..... | CSS 1616-1 |
| DSCH104-E062 | Inch thickness shim..... | .062 inch..... | CSS 1616-2 |

DSCH104 Series - Shim Sets

| DSC Part No. | Description | Thickness | Set includes |
|--------------|--|----------------|---|
| DSCH104-E155 | Five piece inch shim set..... (This set also known as 42-530-3075) | .150 inch..... | (1) .062 inch, (2) .031 inch, (2) .015 inch |

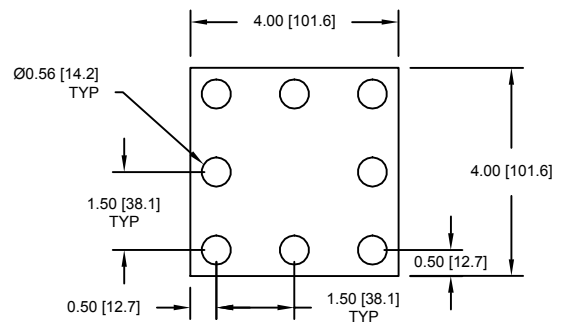

DSCH105 Series - Individual Shims

| DSC Part No. | Description | Thickness | Other part numbers |
|--------------|--------------------------|----------------|--------------------|
| DSCH105-E015 | Inch thickness shim..... | .015 inch..... | CSS 1816-3 |
| DSCH105-E032 | Inch thickness shim..... | .031 inch..... | CSS 1816-1 |
| DSCH105-E062 | Inch thickness shim..... | .062 inch..... | CSS 1816-2 |

DSCH105 Series - Shim Sets

| DSC Part No. | Description | Thickness | Set includes |
|--------------|--|----------------|---|
| DSCH105-E155 | Five piece inch shim set..... (This set also known as 42-530-4000) | .150 inch..... | (1) .062 inch, (2) .031 inch, (2) .015 inch |

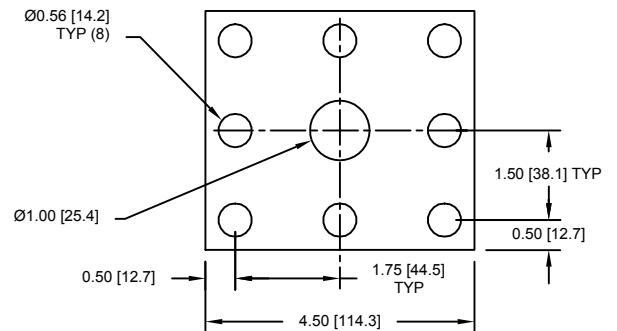

DSCH106 Series - Individual Shims

| DSC Part No. | Description | Thickness | Other part numbers |
|--------------|--------------------------|----------------|--------------------|
| DSCH106-E015 | Inch thickness shim..... | .015 inch..... | CSS 1822-3 |
| DSCH106-E032 | Inch thickness shim..... | .031 inch..... | CSS 1822-1 |
| DSCH106-E062 | Inch thickness shim..... | .062 inch..... | CSS 1822-2 |

DSCH106 Series - Shim Sets

| DSC Part No. | Description | Thickness | Set includes |
|--------------|--|----------------|---|
| DSCH106-E155 | Five piece inch shim set..... (This set also known as 42-530-4025) | .150 inch..... | (1) .062 inch, (2) .031 inch, (2) .015 inch |

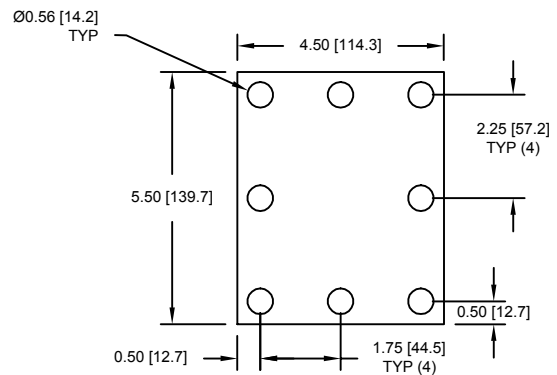

Douglas Stamping Company (248) 542-3940 FAX (248) 542-6342

<http://dougstampco.com> sales@dougstampco.com