

Sets are bulk shipped

Order SHIMS by individual piece or set

Drawings are not to scale

Metric shims over 0.25mm thick are black oxidized

Slots and holes are centered unless otherwise noted

DSCH107 Series - Individual Shims

DSC Part No.	Description	Thickness
DSCH107-E059	Inch thickness shim	.059 inch

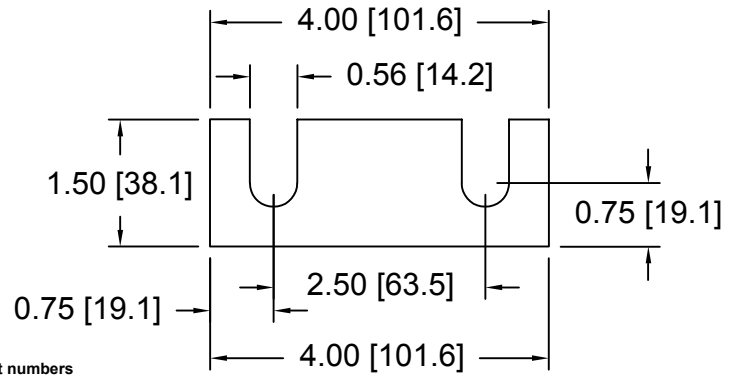

DSCH107 Series - Shim Sets

DSC Part No.	Description	Thickness	Set includes	Other part numbers
DSCH107-E244	Four piece inch shim set	.236 inch	(4) .059 inch	D113063

DSCH108 Series - Individual Shims

DSC Part No.	Description	Thickness
DSCH108-E059	Inch thickness shim	.059 inch

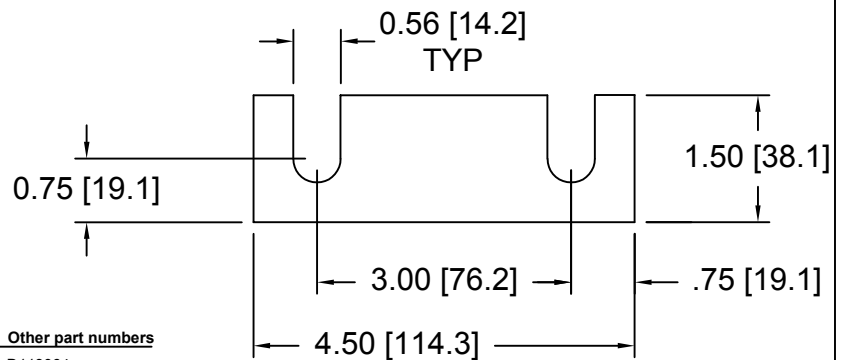

DSCH108 Series - Shim Sets

DSC Part No.	Description	Thickness	Set includes	Other part numbers
DSCH108-E244	Four piece inch shim set	.236 inch	(4) .059 inch	D113064

DSCH109 Series - Individual Shims

DSC Part No.	Description	Thickness
DSCH109-E059	Inch thickness shim	.059 inch

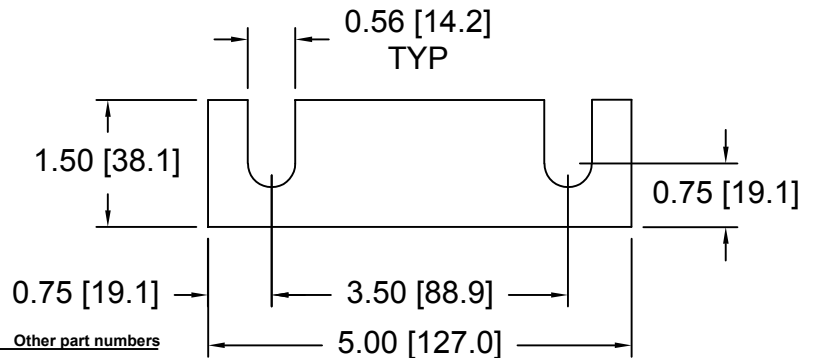

DSCH109 Series - Shim Sets

DSC Part No.	Description	Thickness	Set includes	Other part numbers
DSCH109-E244	Four piece inch shim set	.236 inch	(4) .059 inch	D113065

DSCH110 Series - Individual Shims

DSC Part No.	Description	Thickness
DSCH110-E059	Inch thickness shim	.059 inch

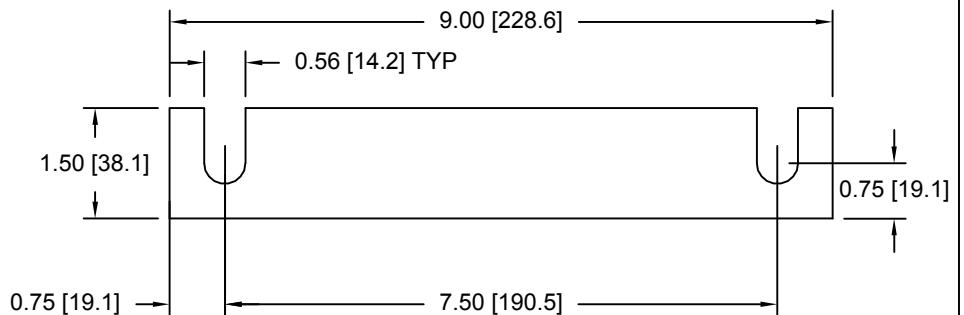

DSCH110 Series - Shim Sets

DSC Part No.	Description	Thickness	Set includes	Other part numbers
DSCH110-E244	Four piece inch shim set	.236 inch	(4) .059 inch	D113066

Douglas Stamping Company (248) 542-3940 FAX (248) 542-6342

<http://dougstampco.com> sales@dougstampco.com