

SPACERS

Drawings are not to scale

Metric spacers are black oxidized Slots and holes are centered unless otherwise noted
Most spacers are etched on the side with thickness

Fiber Optic Laser Cutting

Douglas Stamping Company uses a 2 kilowatt diode pumped fiber optic laser cutting system in addition to our traditional dies and presses. For longer running jobs and those requiring bending and drawing, hard-tooled dies are still the most economical way to produce a wide variety of products. For shorter runs and hard or unusual materials, laser cutting offers greater flexibility and much quicker turn-around.

This state-of-the-art system combines extreme reliability with lower overhead than traditional laser systems, allowing us to quickly and accurately produce shims, spacers, washers, rings, gaskets and other specialty and custom items. We can cleanly and accurately cut most any metal with this system, including copper, brass and titanium.

We are pleased to quote to your drawings. Please send inquiries to us by email at sales@dougstampco.com, FAX at 248 542-3287, or call 542-3940 to discuss your requirements.

DSCP001 Series Spacers

DSC Part No.	Thickness	Other part numbers
DSCP001-M200	2.00mm	FSD 39279-64
DSCP001-M225	2.25mm	FSD 39279-65
DSCP001-M250	2.50mm	FSD 39279-66
DSCP001-M275	2.75mm	FSD 39279-67
DSCP001-M300	3.00mm	FSD 39279-51
DSCP001-M325	3.25mm	FSD 39279-52
DSCP001-M350	3.50mm	FSD 39279-53
DSCP001-M375	3.75mm	FSD 39279-54
DSCP001-M400	4.00mm	FSD 39279-55
DSCP001-M425	4.25mm	FSD 39279-56
DSCP001-M450	4.50mm	FSD 39279-57
DSCP001-M475	4.75mm	FSD 39279-58
DSCP001-M500	5.00mm	FSD 39279-59
DSCP001-M525	5.25mm	FSD 39279-60
DSCP001-M550	5.50mm	FSD 39279-61
DSCP001-M575	5.75mm	FSD 39279-62
DSCP001-M600	6.00mm	FSD 39279-63

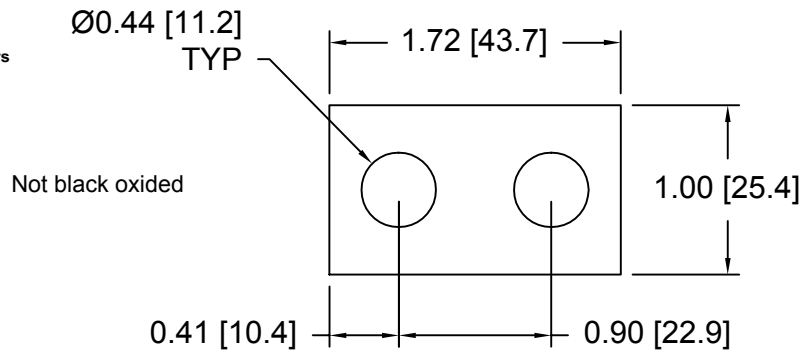

DSCP002 Series Spacers

DSC Part No.	Thickness	Other part numbers
DSCP002-M200	2.00mm	FSD 39280-64
DSCP002-M225	2.25mm	FSD 39280-65
DSCP002-M250	2.50mm	FSD 39280-66
DSCP002-M275	2.75mm	FSD 39280-67
DSCP002-M300	3.00mm	FSD 39280-51
DSCP002-M325	3.25mm	FSD 39280-52
DSCP002-M350	3.50mm	FSD 39280-53
DSCP002-M375	3.75mm	FSD 39280-54
DSCP002-M400	4.00mm	FSD 39280-55
DSCP002-M425	4.25mm	FSD 39280-56
DSCP002-M450	4.50mm	FSD 39280-57
DSCP002-M475	4.75mm	FSD 39280-58
DSCP002-M500	5.00mm	FSD 39280-59
DSCP002-M525	5.25mm	FSD 39280-60
DSCP002-M550	5.50mm	FSD 39280-61
DSCP002-M575	5.75mm	FSD 39280-62
DSCP002-M600	6.00mm	FSD 39280-63

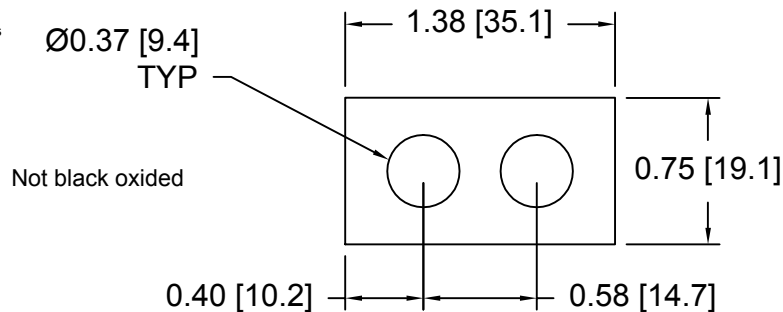

Douglas Stamping Company (248) 542-3940 FAX (248) 542-6342

<http://dougstampco.com> sales@dougstampco.com